

DRIVER	<b>Shoki Takahata</b>	
DATE	<b>November 25, 2018</b>	
TRACK	<b>SRT, 2018 Japan Nats</b>	

## TRACTION

LOW <input type="checkbox"/>	MEDIUM <input checked="" type="checkbox"/>	HIGH <input type="checkbox"/>
------------------------------	--	-------------------------------

## LAYOUT

SLOW <input type="checkbox"/>	MIXED <input checked="" type="checkbox"/>	FAST <input type="checkbox"/>
-------------------------------	---	-------------------------------

## ENGINE

TYPE	<b>O.S Speed R21 Euro Spec</b>	
GLOW PLUG/FUEL PIPE/MANIFOLD	<b>RP7</b>	<b>Nitro-X</b>
	<b>O.S-T-2080</b>	<b>O.S</b>

## CLUTCH SETTINGS

SHOE#/BELL#	<b>KIT</b>	<b>KIT</b>
CLEARANCE(mm) / AXIALPLAY(mm)	<b>0.6</b>	<b>0.2</b>
SPRING#/TENSION(mm)	<b>KIT</b>	<b>0.1</b>

## TYRES

### CONTROLLED

FRONT		BRAND	REAR	
LEFT	RIGHT		LEFT	RIGHT
		<b>Matrix</b>		
		SHORE		
<b>68</b>	<b>68</b>	DIAMETER START	<b>75</b>	<b>75</b>
		DIAMETER 5min		

## SHOCK ABSORBERS

### FRONT

PISTON	<b>1.1x2</b>	PISTON	<b>1.1x2</b>
OIL	<b>500</b>	OIL	<b>700</b>
SPRING	<b>SMJ Blue</b>	SPRING	<b>SMJ Pink</b>

### REAR

2,2 <input type="checkbox"/>	2,3 <input checked="" type="checkbox"/>	2,4 <input type="checkbox"/>	2,5 <input type="checkbox"/>
------------------------------	---	------------------------------	------------------------------

### ANTI ROLL BAR REAR

2,8 <input type="checkbox"/>	2,9 <input type="checkbox"/>	3,0 <input checked="" type="checkbox"/>
------------------------------	------------------------------	---

## SERVO SAVER POSITION

FORWARD <input type="checkbox"/>	<input checked="" type="checkbox"/>	REARWARD <input type="checkbox"/>
----------------------------------	-------------------------------------	-----------------------------------

## PINION 1st

15T <input checked="" type="checkbox"/>	16T <input type="checkbox"/>
---	------------------------------

## PINION 2nd

19T <input checked="" type="checkbox"/>	20T <input type="checkbox"/>
---	------------------------------

## SPUR 1st

48T <input checked="" type="checkbox"/>	49T <input type="checkbox"/>	50T <input type="checkbox"/>
---	------------------------------	------------------------------

## SPUR 2nd

45T <input checked="" type="checkbox"/>	46T <input type="checkbox"/>	47T <input type="checkbox"/>
---	------------------------------	------------------------------

### STEERING ROD POSITION

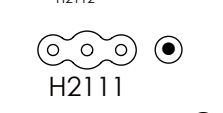
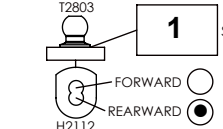

### CASTER ANGLE (mm)

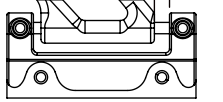
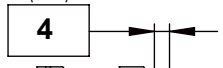

### UPPER ARM POSITION

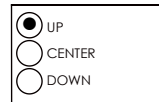

CAMBER	<b>1.5</b>	<b>1.5</b>
	LEFT	RIGHT



SHIM UNDER H0180(mm) **1**

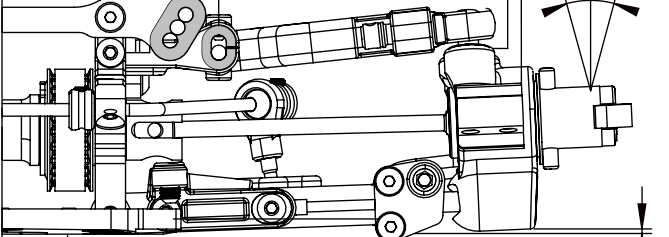

### SHOCK/UPPER ROD POSITION

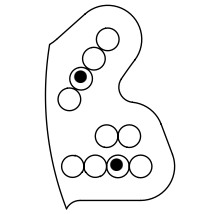

### SHOCK POSITION H2159



### LOWER ARM POSITION



### H0466G POSITION

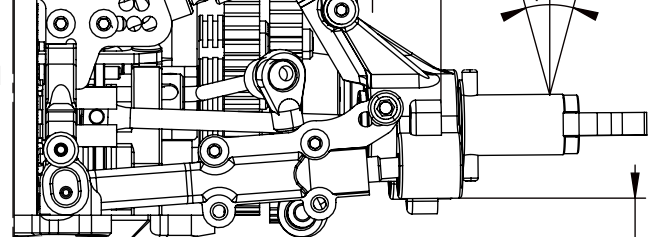
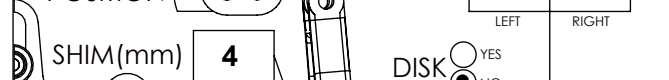

### FRONT TOE

LEFT <b>1.5</b>	RIGHT <b>1.5</b>
-----------------	------------------

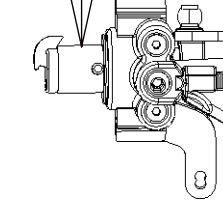

### RADIOPLATE FLEX

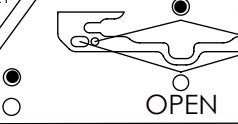

### H2415 MOUNTED ON:



### REAR TOE

LEFT <b>3</b>	RIGHT <b>3</b>
---------------	----------------

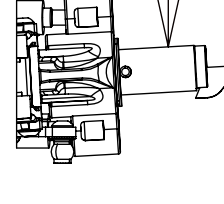

### WEIGHT DISTRIBUTION

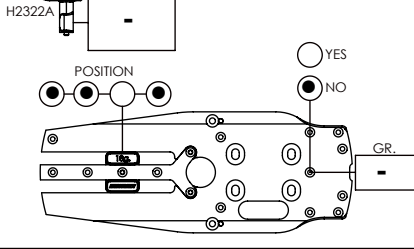

### AERO/SETTING

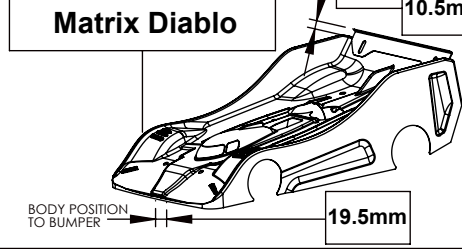

NOTES: